

03/00380/New

OFFICE USE ONLY

Date Received 18/8/03

Application Number 03/00380

### TREE FORM

#### RUNNYMEDE BOROUGH COUNCIL

APPLICATION FORM FOR PERMISSION TO FELL, LOP OR PRUNE A TREE(S) PROTECTED BY A TREE PRESERVATION ORDER TREE(S), TREE(S) IN CONSERVATION AREAS OR TREE(S) SUBJECT TO A CONDITION IMPOSED ON A PLANNING PERMISSION.

Three copies of this form should be completed together with three copies of an accurate plan (preferably Ordnance Survey based) showing the location of the tree(s), see example on the reverse, and sent to :-

The Borough Technical Services Officer,  
Runnymede Borough Council,  
Civic Offices,  
Station Road,  
Addlestone,  
Surrey, KT15 2AH.

Please read the notes on the reverse of this page before you complete the application.

- 1. Please give the address or location of land where the tree(s) are growing  
VIRGINIA PARK, CHRISTCHURCH RD  
VIRGINIA WATER, SURREY GU25 4SH
- 2. Name and address and telephone number of applicant. (Daytime telephone number to arrange access to the site.)  
LIZ ADAMS - ESTATE MANAGER  
ADDRESS A/A - 01364 845276
- 3. Name, address and telephone number of Agent acting on your behalf (if applicable) to whom correspondence will be sent.  
ELMBRIDGE TREE SERVICES LTD  
6A HARE LANE CLAYGATE ESHER  
SURREY KT10 9BS
- 4. Please describe the work you wish to carry out in as much detail as possible showing which trees (and species and size if known) are affected (use separate sheet if necessary). Please explain why the work is necessary.  
SEE ATTACHED  
APPENDIX A
- 5. Please state how many trees are to be felled.  
TWO
- 6. If known :-

Is the tree(s) covered by (tick box)

<input checked="" type="checkbox"/>	<input type="checkbox"/>	<input type="checkbox"/>
Tree Preservation Order	Condition	Conservation Area

Signed: T. Cahin Dated: 15-08-03

If you have any queries please telephone WEYBRIDGE (01932) 838383 and ask for the Development Control Section.

NOTES

1. Some individual trees and some groups of trees are the subject of Tree Preservation Orders, which means that any landowner or occupier must obtain the Borough Council's permission to fell, lop or prune such trees, unless the trees are dead, dying or dangerous (in which case Council permission is not required). In order to establish whether protected trees are dead, dying or dangerous, you may contact the Borough Technical Services Officer's Department on 01932 838383. If trees are felled or lopped without permission you may be prosecuted, fined and required to replace with new trees, including replanting in the same place.
2. All trees in Conservation Areas exceeding 75mm in diameter at 1.5 metres above ground level are automatically protected by law (again unless they are dead, dying or dangerous) and the Council must be notified of any proposed works to such trees. In this case, the Council is required to make a decision within six weeks.
3. In some instances, trees are protected by a condition attached to a planning permission and the procedure relating to trees protected by a Tree Preservation Order (Note 1 above) should be followed.
4. When the Council receives your application, an officer will inspect the tree(s) and you will be notified, in writing, of the Council's decision shortly thereafter.
5. If your application is refused, then you have a right of appeal to the Department of the Environment. You should write to :-

Government Office for the South-East,  
Planning Directorate,  
1st Floor,  
Bridge House,  
1 Walnut Tree Close,  
Guildford,  
Surrey, GU1 4GA.

6. Finally, it is important to remember that these procedures are necessary in order to safeguard the Borough's landscape and environment.

AN EXAMPLE OF A TYPICAL PLAN TO ACCOMPANY AN APPLICATION OR NOTICE

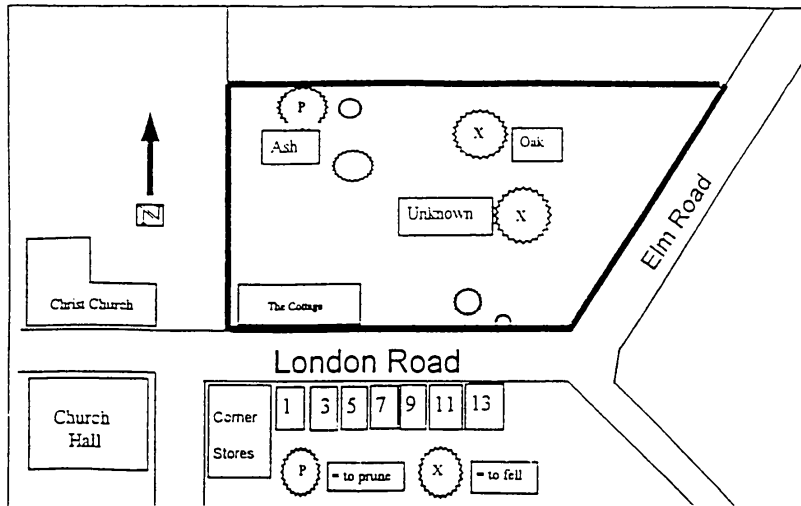

When drawing your plan please :

1. Try and locate your house in relation to nearby properties.
2. Ensure that all relevant roads are named.
3. Ensure that the trees are clearly marked and numbered on the plan.
4. Put the type of tree if known.

**APPENDIX A**

**PROPOSED TREE WORKS AT VIRGINIA PARK**

Tree No.	Species	Proposed Works	Reasons
7	London Plane	Reduce all laterals to rebalance crown and install one 4 tonne cable brace to help prevent main stem splitting out.	Large split down main stem, held together by undersized old steel cable.
8	Copper Beech	Remove all major deadwood over neighbouring property and throughout the crown. Reduce tips encroaching on road.	Safety - one side of tree previously removed, reducing tips will help balance crown.
9	Horse Chestnut - mature	Lift from neighbouring rooftop and property.	General maintenance.
11	Eucalyptus x 2	Sectional fell and grind out stumps.	Outgrown present position, make way for specimen neighbouring Ash trees.
15	Lime x 3	Lift to 4m, trim from light, remove all basal growth.	General maintenance. Encroaching on highway and light.
16	Lime	Remove all major deadwood, lift from light, trim all basal growth.	General maintenance. Encroaching on highway and light.

ELMBRIDGE TREE SERVICES LIMITED - AUGUST 2003

03 / 0986