

N.B.
FINISH TO BE ROAD
PLANNINGS AND KERB
STONES FOR BAY MARKING
POINTS.

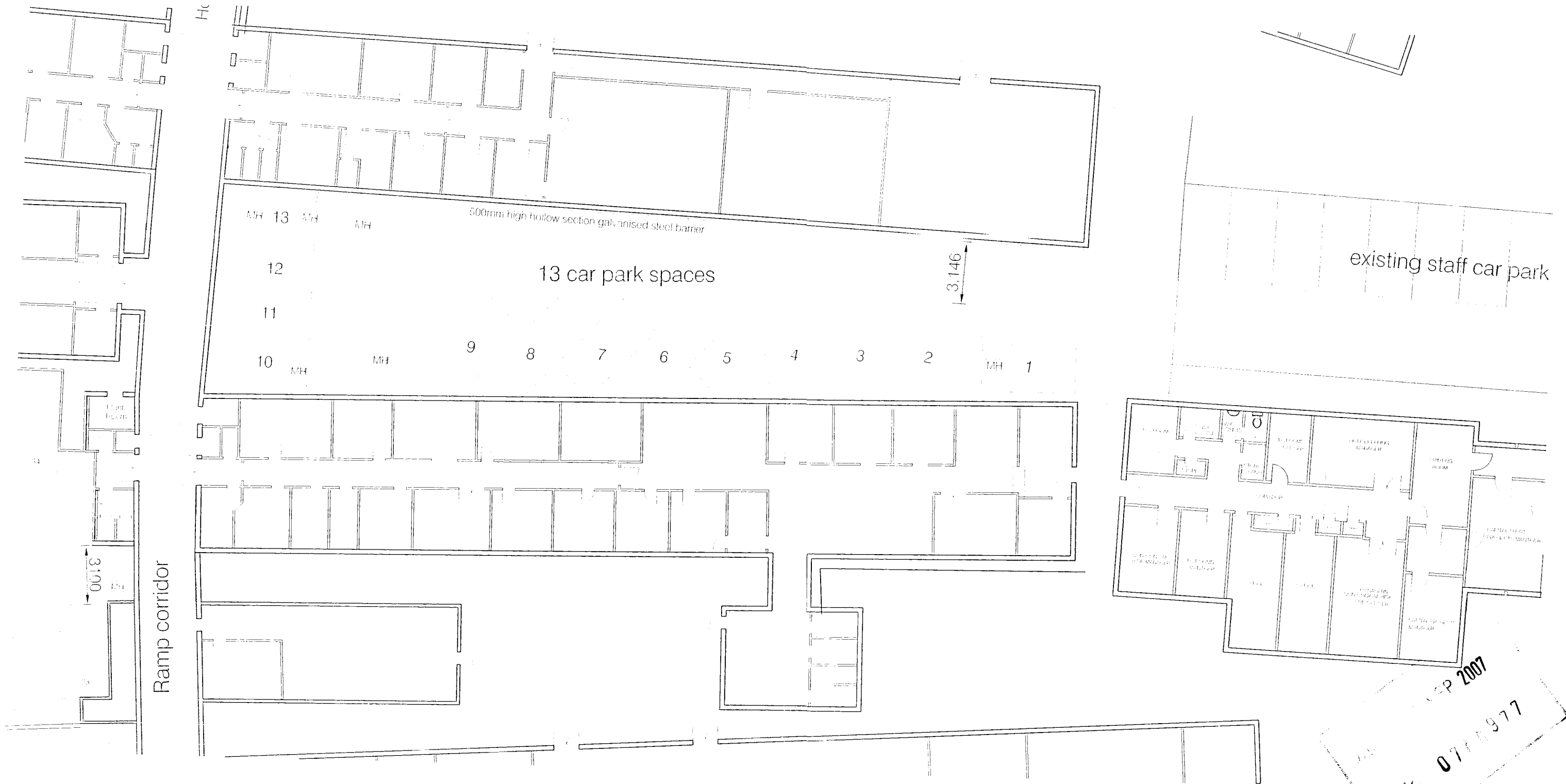

13 JUN 2007
No 0774977

REV	DATE	DRAWN	DESCRIPTION

NEW STAFF CAR PARKS
(BETWEEN HR & BOARD ROOM BUILDINGS)

Ashford & St Peter's NHS Trust
Facilities Department
St Peter's Hospital
Guildford Road
Chertsey, Surrey, KT16 0PZ
Telephone: 01932 722549 Fax 01932 722881



CLIENT	PROJECT	SCALE	DATE	DRAWN	REV
ST. PETER'S HOSPITAL <td>NEW STAFF CAR PARKS BETWEEN HR & BOARD ROOM BUILDING</td> <td>1:200 A3</td> <td>JUN2 2007</td> <td>FC</td> <td>01</td>	NEW STAFF CAR PARKS BETWEEN HR & BOARD ROOM BUILDING	1:200 A3	JUN2 2007	FC	01
		DATE	CP-04		